

Catalog Number _____
 Type _____
 Date _____
 Prepared By _____
 Project _____

DTDLED LED Dusk to Dawn



Simkar's LED Dusk-to-Dawn luminaires replace existing 70 watt pulse start metal halide fixtures while consuming just 30 watts and operating for 50,000 hours. The DTDLED is ideal for area, yard, security, and service road applications.

HOUSING Rugged die-cast aluminum housing with powder coat gray finish. Cast heat dissipating fins. Internal slip fitter.

ELECTRICAL Fully wired for 120V operation. Power factor >0.9.

LEDS LM80 certified 50,000 hour operating life (L70).

MOUNTING Standard 1-5/8" arm (included) or surface mount

- Factory-installed photocell for automatic dusk to dawn operation
- Energy efficient, high power LED array produces intense, uniform illumination
- Consumes 30W; up to 50% energy savings vs HID
- 4100K color temperature (typical)
- Light output 1800 lumens (equivalent to 70W PSMH)
- 50,000 hour operating life (L70)
- Thermally efficient diecast aluminum housing maximizes life of LEDs
- Durable, smooth gray powder-coat finish

- UV stabilized prismatic acrylic lens
- Wall or pole mount
- Mounting arm and hardware included
- UL/cUL wet location
- Temperature range -22°F (-30°C) to 104°F (40°C)
- 5 Year warranty
- Fixture performance tested to LM79

LED Dusk to Dawn Yard Light Ordering Information

Ordering Code	Description
DTDLED30	30W 120V LED 12" Yard Lite w/PC & 24" Arm

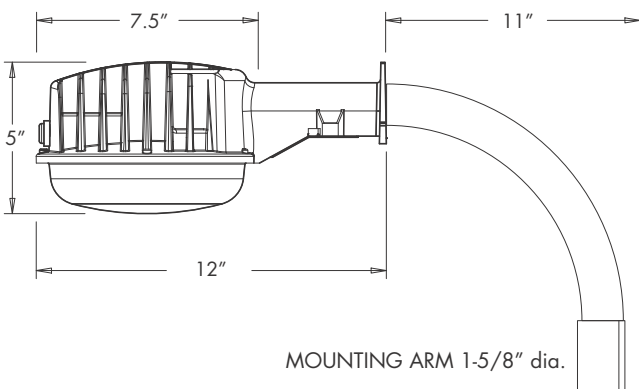

LED Dusk to Dawn Performance

DTDLED30	
Input power	30 watts
Light output*	1800 lumens
Efficacy	60 lumens/watt

*Delivered

Dimensions are nominal

FOR CUSTOM OPTIONS AND ACCESSORIES, CONTACT FACTORY. SPECIFICATIONS SUBJECT TO CHANGE WITHOUT NOTICE.

Photometric Data (2x2)

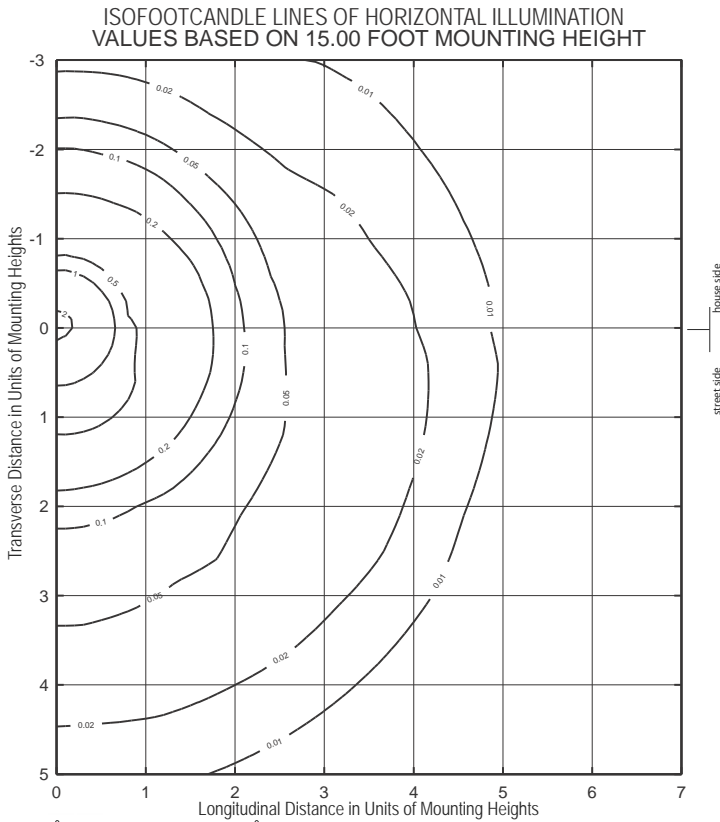

MAXIMUM PLANE AND CONE PLOTS OF CANDELA

